

Reproduced from Ordnance Survey digital map data © Crown copyright 2018. All rights reserved. Licence number 010031673. May contain public sector information licensed under the Open Government Licence v 3.0.

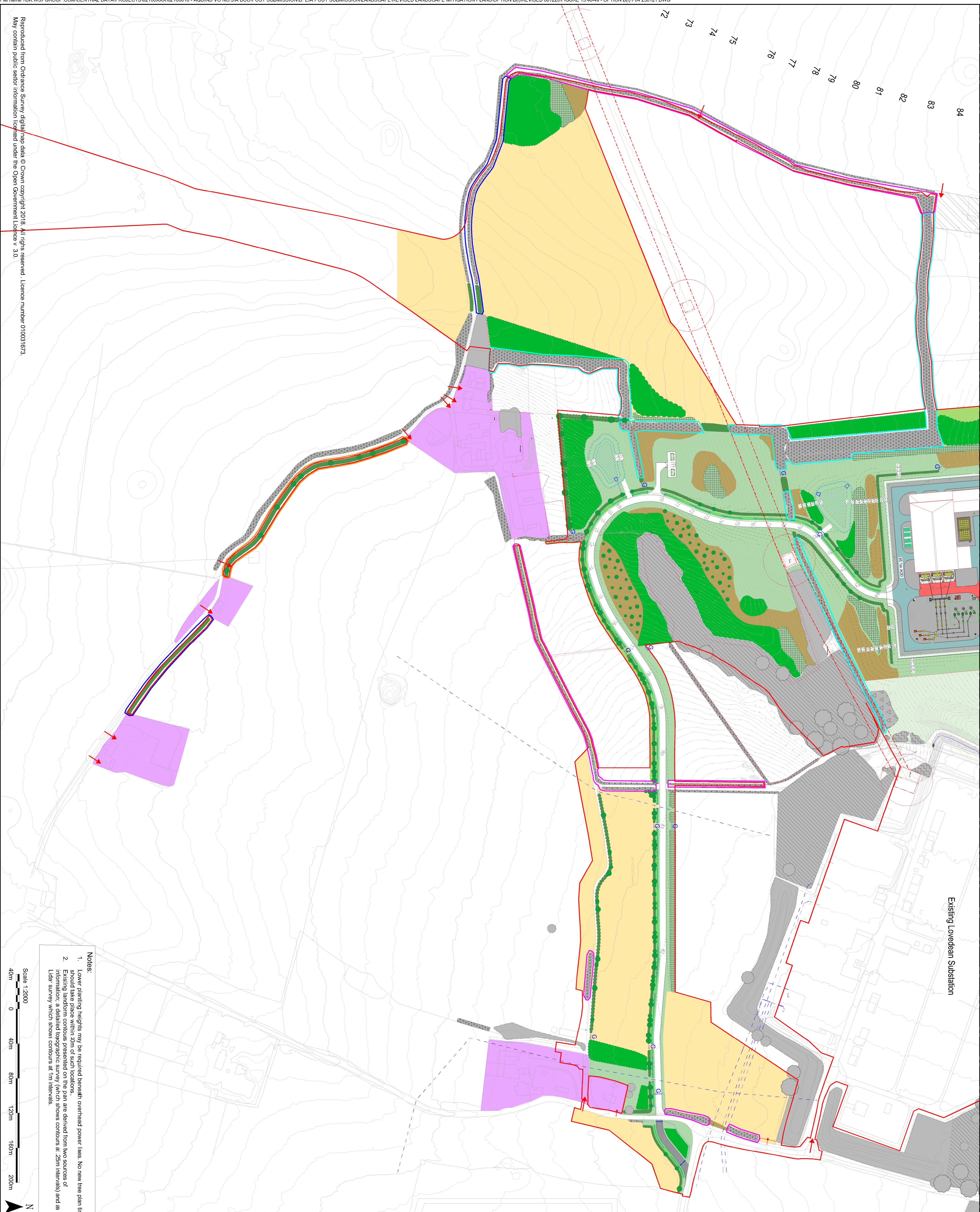

Existing Lovedean Substation

Legend

- Existing Order Limits
- Access point
- Existing ground level contour
- Existing non-residential development
- Existing residential development
- Existing underground cable route
- Existing underground cable route
- Monitor's Way (PROM)
- Indicative existing overhead power lines
- Existing fencing
- Existing woodland
- Existing ancient woodland
- Existing native hedgerows
- Existing native hedgerows with hedgerow trees
- Existing grassland / scrub
- Existing scrub
- Existing National Grid red/green planting
- Existing mature trees
- Existing arable farmland
- Existing pasture
- Existing recreation area
- Existing semi-improved grassland
- Bare ground
- Proposed contours
- Proposed native hedgerow
- Proposed native hedgerow with hedgerow trees
- Proposed native mixed woodland (up to 15m)
- Proposed native mixed woodland (up to 25m)
- Proposed native mixed woodland (up to 25m)
- Proposed scrub
- Proposed scrub with scattered trees
- Proposed calcareous grassland
- Proposed meadow grassland
- Proposed attenuation pond
- Vegetated verges and infiltration swales (marginal planting)
- Proposed access road
- Proposed additional access road
- Proposed gate
- Proposed access point
- Proposed fence
- Management of existing hedgerows
- Gap up through new hedgerow planting
- New hedgerow planting to replace hedgerows grubbed out
- With hedgerow trees
- Gap up with new hedgerows and maintain at existing height
- Restrict removal of hedgerows and maintain at existing height, introduce new hedgerow trees where possible and gap up with new hedgerow planting where necessary

Infrastructure Planning (Applications Prescribed Forms & Procedures) (Regulations 2009 - Regulation 5(2)(a))

REV	DATE	BY	DESCRIPTION	CHK	APP
04	25/01/2021	JK	REVISION OF PROPOSED WOODLAND	JK	JK
03	06/12/2020	DW	REVISED GREEN LIMITS AND FURTHER AMENDMENTS	JK	JK
02	06/09/2020	DW	REVISIONS TO GREEN AMENDMENTS	JK	JK
01	06/11/2019	DW	FIRST ISSUE	JK	JK

FINAL



3rd Floor, Kings Orchard, 1 Queen St, Bristol, BS2 0HQ, UK
T+ 44 (0) 1179 306 200
wsp.com



CLIENT: AQUIND Interconnector

Figure 15.49: Indicative Landscape Mitigation Plan Option B(i) (south)

SCALE 1:1	DATE	DESIGNED	DRAWN	CHECKED	DATE	APPROVED
1:2000	08/11/2019	MB	DW	MB	08/11/2019	AF

PROJECT NO: EN020022
DRAWING NO: EN020022-ES-15.49
DATE: 04